

# It's your Water<sup>®</sup>

---

## USER GUIDE

Woder TC (Twist-Connect)  
Replacement Cartridges





# INSTALLATION GUIDE

For Woder Single-Stage & Dual-Stage Replacement Cartridges

## MODELS:

WD-G4-REP (WD-GEN4-2515-TC) | WD-HMG4-REP  
WD-FRM-REP | WD-20m-REP

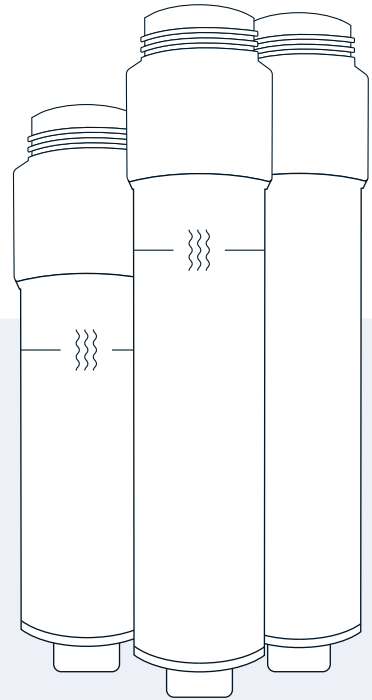

Minimum Working Pressure: 40 psi. Maximum Working Pressure: 70 psi. Flow rate: 0.5 GPM @60psig. Maximum Operating Temperature: 100°F. Minimum Operating Temperature: 35°F. Capacity: WD-GEN4-2512TC tested for 1700 gallons. Warranty: 1-year replacement guarantee. Ingredients: Formula Clearbrook GEN4. Systems are tested and certified under industry standards. Water Source: This water filter unit is to be used in conjunction with municipally treated water. Safety Warning: Do not use water that is microbiologically unsafe or unknown quality without adequate disinfection before or after the system. Compliance: The system and installation shall comply with applicable state and local regulations. Chlorine Reduction: The Chlorine influent concentration shall be specified as 2 mg/l. The reduction requirement is equal or greater than 50%.

**woder**  
the water company™

FOR INSTALLATION QUESTIONS OR CUSTOMER SUPPORT,  
PLEASE CONTACT US AT [WWW.WODER.COM/SUPPORT](http://WWW.WODER.COM/SUPPORT)

# Woder TC cartridge replacement Guide

WD-G4-REP (WD-GEN4-2515-TC) | WD-HMG4-REP WD-FRM-REP | WD-20m-REP

## STAGING SEQUENCE:

When utilizing a dual-stage system, the ADVANCED Gen4 (G4) cartridge should always be the second and final stage of the system cycle, located on the right. This staging sequence ensures optimum filtration capabilities, efficiency, and taste.

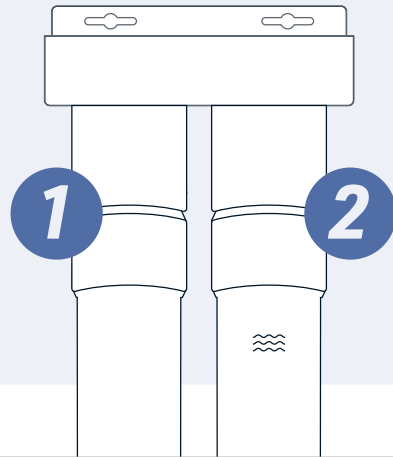

1

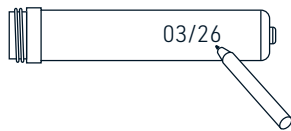

Remove the red or yellow sealant. Write the installation date on the cartridge for future reference.

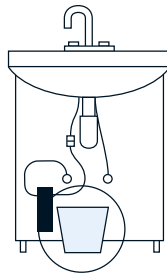

Place a bucket under the Woder filter.

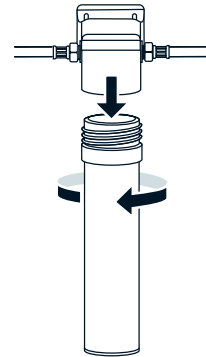

Unscrew the used cartridge. The water shuts off automatically (there are built-in valves in the system).

2

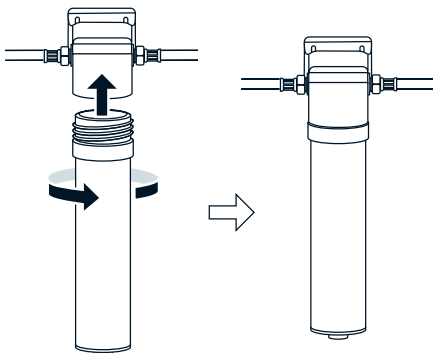

Screw in the new cartridge. The water turns back on when you screw the new filter on.

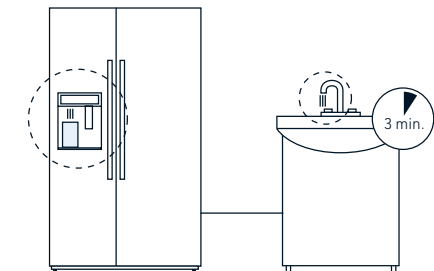

Activate the filter by allowing the water to flow for 3 minutes.